

BT8423

ADJUSTABLE DROP FLAT SCREEN CEILING MOUNT WITH TILT

Designed to ceiling mount screens up to 110lbs, the BT8423 features an adjustable drop of 24.6" - 37.4"* in increments of 1". The mount uses B-Tech's unique 'Torsion-Tilt' mechanism for easy tilt up to +/-15°. Levelling screws are included on the interface arms to finely adjust the screen height and locking screws help prevent unauthorised removal of the screen. Cover plates are supplied for a neat and tidy installation.

SPECIFICATIONS

Recommended Screen Size	up to 47"
Max load	110lbs
VESA® & non-VESA fixings	up to 327 x 200
VESA® compatibility	up to 200 x 200
Screen tilt	+ / - 15°
Ceiling drop	Min. 24.6" - Max. 27.4" **
Colour	Black

FEATURES

- 1** Quick and easy 'push button' height adjustment in 1" increments
 - 2** Levelling screws allow adjustment of the screen height once mounted
 - 3** Security locking screws and Allen key provide a secure installation
 - 4** Integrated cable management
- Unique 'Torsion-tilt' mechanism for tool-less tilt adjustment
 - Suitable for landscape or portrait mounting
 - Lateral adjustment of screen once mounted
 - Cover plate included for a smart installation
 - Simple 'hook-on' installation with all mounting hardware included



RECOMMENDED MAX SCREEN	MAX SCREEN WEIGHT	MAX VESA	POST INSTALL ALIGNMENT	HEIGHT ADJUSTMENT	TILT	QR CODE
47" 120cm	110lbs	200			15° 15°	

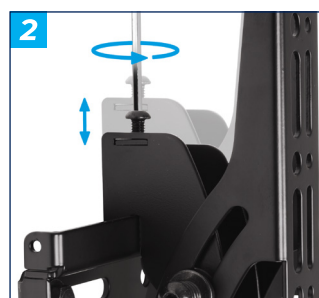

*To the center of the mount

