

BT8416

TWIN SCREEN VC WALL MOUNT FOR SCREENS UP TO 65"

BT8416 is a premium wall mounting solution designed to mount two screens side by side for video conferencing applications. The mount features an adjustable VC shelf that gives the user the flexibility of mounting a VC camera above or below the screens. Additional features include adjustable levelling screws for easy height adjustment and safety screws that help to prevent unauthorized removal of the screen.

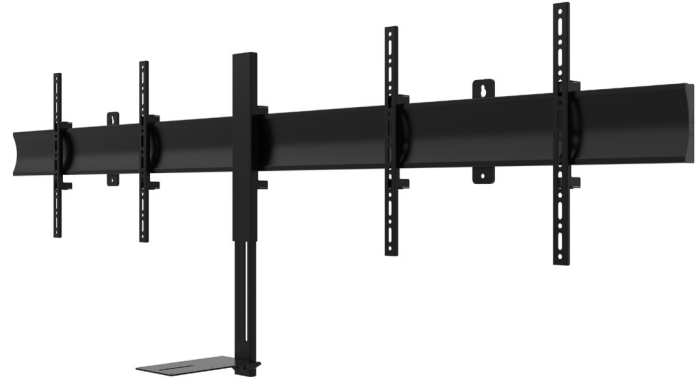

SPECIFICATIONS

Recommended screen size	50" - 65"
Max load	154lbs per screen
VESA® & non-VESA fixings	up to 600 x 400
Dimensions	W: 79" H: Min: 17.5" Max: 33" D: 11.4"
Dimensions	W: 4.7" H: 0.1" D: 9.3"
Color (mounting rail)	Black

FEATURES

- 1 Includes VC camera shelf that can be fitted above or below the screens
 - 2 Interface arms include levelling screws to adjust the height of the screens
 - 3 Safety screws prevent unauthorized removal of the screens
 - 4 Keyhole mounting for easy installation
- Designed suitable for mounting two screens side by side
 - High-end aesthetic quality
 - VC shelf fits most cameras with 1/4" thread with 100 x 100 fixing points
 - Simple 'hook-on' screen installation with all mounting hardware included



RECOMMENDED MAX SCREEN	MAX LOAD	MAX VESA	POST INSTALL ALIGNMENT	QR CODE
65" 165cm	154lbs per screen	600 x 400	← →	



BT8416

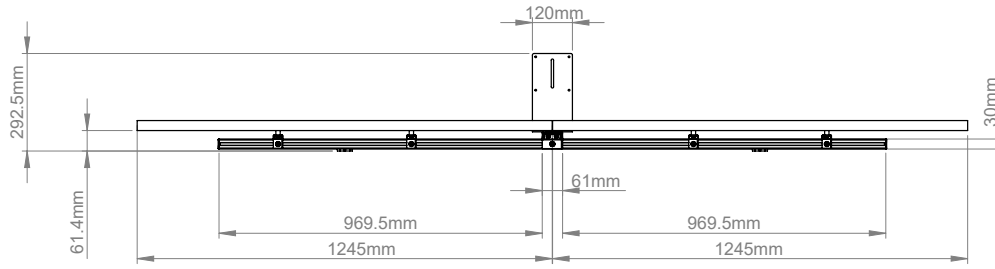

TOP VIEW

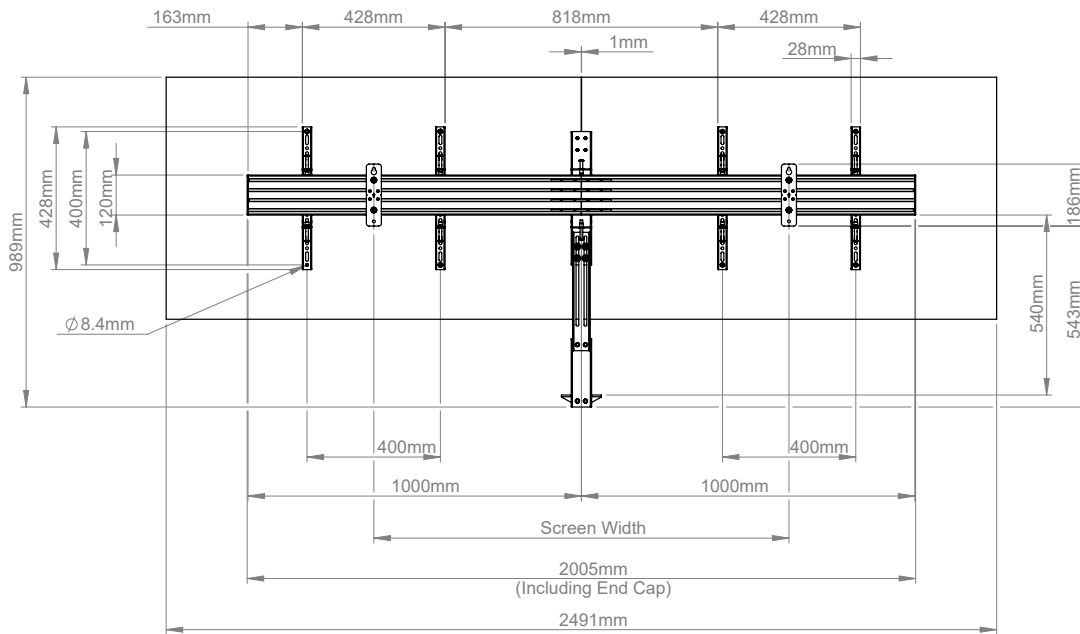

FRONT VIEW

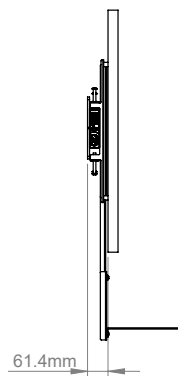

SIDE VIEW

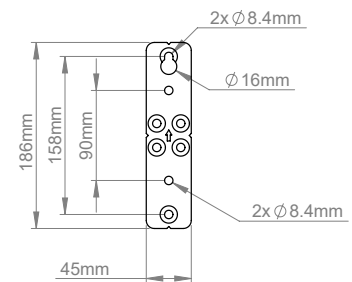

WALL BRACKET

ORDERING INFORMATION

COLOR	ORDER REF	BARCODE
Black	BT8416/B	5019318305603

RELATED PRODUCTS

PRODUCT CODE	NAME	DESCRIPTION
BT8415	Twin Screen VC Wall Mount	For screens up to 49"
BT8516	Twin Screen VC Trolley/Stand	For screens up to 65"
BT8390-SA	Adjustable Accessory Mounting Arm	Ideal for VC cameras when used in conjunction with BT7863
BT7863	Small Accessory Shelf	Can be mounted directly to; walls or accessories such as BT8390-SA

© 2022 B-Tech AV Mounts, Ltd. All rights reserved.
 The information in this specification sheet reflects the current technical specifications at the time of printing.
 We reserve the right to change the technical or physical specifications without prior notice. The B-Tech name and the B-Tech logo are registered trademarks of B-Tech AV Mounts, Co. Ltd.
 B-Tech is not responsible for any damage or loss of data caused by improper installation or mounting on unstable structures. Any reproduction or use without our permission is prohibited.
 Specification sheet is strictly for reference, unless prior written permission is granted by B-Tech AV Mounts, Co. Ltd. 2022.

SS-BT8416-080725