

BT8312

SLIMLINE SOFT-OPEN FULL-SERVICE VIDEOWALL MOUNT

Designed to make video wall installations as quick and simple as possible, this modular video wall mount can be used to create unlimited video wall configurations in both landscape and portrait format. The BT8312 low profile design is ideal for mounting into walls with a shallow recess or when space in front of the wall is minimal. 8 points of micro-adjustment makes accurate screen alignment quick and easy and the soft opening features a controlled release enabling access to the rear of the mounted screen for servicing and maintenance.



SPECIFICATIONS

Recommended screen size	42" - 75" (46" - 75" in portrait)
Max load	110lbs
VESA® compatibility as standard	200 x 100 up to 400 x 400
VESA® compatibility with adaptors	up to 600 x 400*
Flat to wall depth	2.73" * (+/-0.29" with micro-adjustment)
Popped out depth	8.75" * (+/-0.29" with micro-adjustment)
Tool-less micro-adjustment	+/-0.29" per corner
Screen height adjustment	+0.59"

FEATURES

- Slim design ideal for low profile installs on walls & recesses
- 1** Modular mount for an unlimited number of videowall configurations
- 2** Pop-out system with soft opening provides safe and easy service access
- 3** 8 points of micro-adjustment for depth, height & lateral screen adjustment
- 4** Tool-less micro-adjustment at each corner for seamless display alignment
- Suitable for landscape or portrait screen mounting
- Keyhole mounting for quick and easy installation
- Integrated locking mechanism prevents accidental pop-out of mount
- Safety screws help prevent unauthorized removal of screens
- Suitable for both wall or pole mounting
- Spacers kits are available separately to speed up installation times
- Adapter arms for VESA 800 x 400 fixings (BT7565) available separately

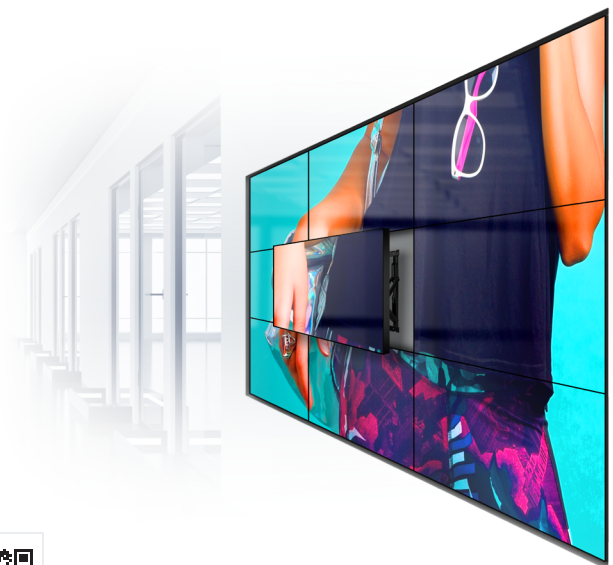

RECOMMENDED MAX SCREEN	MAX LOAD	MAX VESA	MICRO ADJUSTMENT	POST INSTALL ALIGNMENT	COLLAR COMPATIBLE	UL CERTIFICATION	QR CODE
75" 190cm	110lbs	600 x 400					

Patterns: US 11,841,111 B2

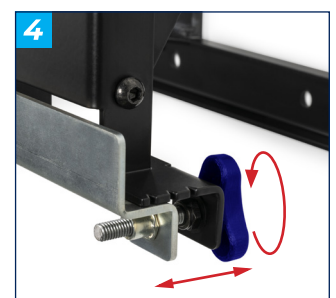
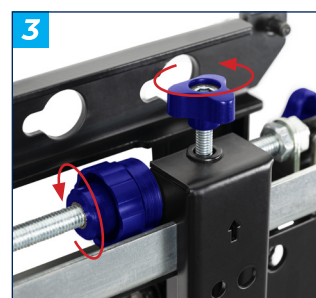
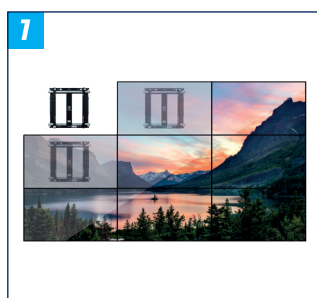

*Please note using the included Interface Adaptor Arms to mount VESA 600 x 400 screens will increase the total depth of the product by 0.23" for a total depth of: 2.97" or 8.99" whilst popped out.

